



## FEATURES

- ▼ Corrosion resistant enclosures in cast marine brass or copper free aluminum.
- ▼ For locations where flammable gases are usually present.
- ▼ Range of conduit hub sizes in  $\frac{1}{2}$ " ,  $\frac{3}{4}$ " or 1" NPT.
- ▼ Choice of one, two, three or four conduit opening configurations.
- ▼ 5 year warranty.

## APPROVALS

- ▼ UL 886 - Outlet Boxes F/Hazardous Locations
- ▼ Class I Division 1 Groups C & D
- ▼ Class II Division 1 Groups E, F & G
- ▼ Type 4X
- ▼ ABS
- ▼ Conforms to IP 66

## APPLICATIONS

- ▼ Hazardous locations
- ▼ Marine and wet environments
- ▼ Offshore oil and gas platforms
- ▼ Drill ships and exploration vessels
- ▼ Tankers
- ▼ Petrochemical Plants/Refineries

## OPTIONS

To obtain a luminaire with one of the following options listed below add the following suffix:

- ▼ 4 Pole 20 Amp Terminal Block

T4

## DIMENSIONS

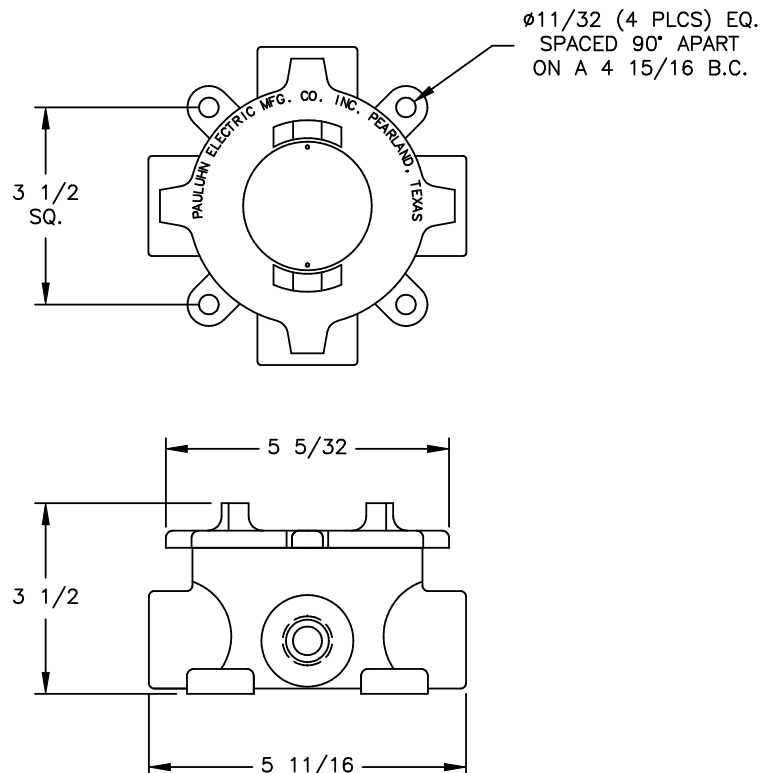



# EXPLOSION PROOF CLASS I DIVISION 1 SCREW COVER JUNCTION BOX

## TECHNICAL SPECIFICATIONS

### HOUSING

Cast marine brass or copper free aluminum with a natural finish.

### MOUNTING

Surface mounted via four  $\varnothing \frac{5}{16}$ " mounting holes.

### CONDUIT OPENING SIZE AND CONFIGURATION

Can be supplied with one, two, three or four outlets. Two outlet units can be supplied with the outlets 180° or 90° apart. Hub sizes are available in  $\frac{1}{2}$ ",  $\frac{3}{4}$ " or 1" NPT.

### GASKET

One piece neoprene gasket provides a watertight seal between the cover and housing.

### TERMINAL BLOCKS

Can be supplied with a four pole 20 Amp terminal block, if required.

## ORDERING REFERENCES

I. SERIES DESIGNATION	II. MATERIAL DESIGNATION	III. CONDUIT HUB SIZE	IV. CONDUIT OPENING CONFIGURATION	V. OPTIONAL SUFFIXES
EPJ 505	A Aluminum B Brass	50 $\frac{1}{2}$ " NPT	1 One conduit opening	T4 4 Pole 20 Amp Terminal block
		75 $\frac{3}{4}$ " NPT	2 Two conduit openings 180° apart	
		10 1" NPT	2L Two conduit openings 90° apart	
		3 Three conduit openings		
		4 Four conduit openings		